

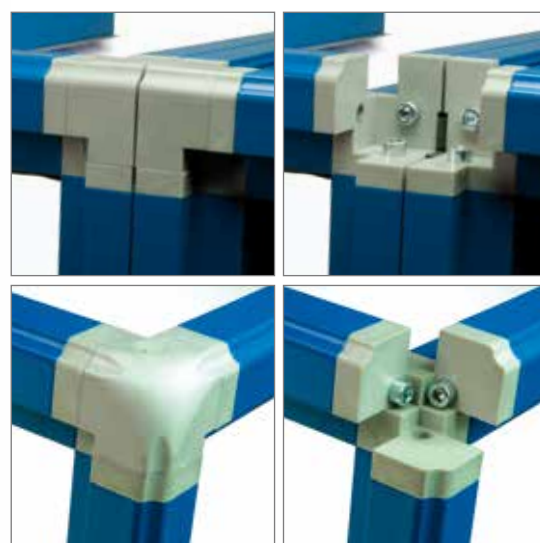

TESTED*
D1 L1
T2 TB2
DIN EN 1886
*MEASUREMENTS CARRIED OUT BY TÜV SÜD INDUSTRIE SERVICE GMBH

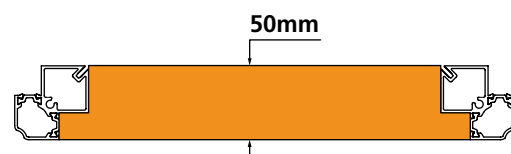

The Thor system is based on the screw tightening between the corner and the profile.

With its specific design, it allows making cold structures and thermal break, simplifying assembling procedures.

It is a system designed to ensure a perfect closure between the panels inside the central unit and leakages are reduced to the minimum, thanks to its specific gaskets.

Thor is a TÜV certified system according to EN 1886 standard, available for 50 mm / 1.97" double height panels. Given Thor system's great success, APS Arosio keeps evolving it with a new kit of accessories: panel block, handle and hinge.

A natural evolution that gives the possibility to choose between high level solutions for all air handling units constructors that aim to high quality products and that only APS Arosio is able to provide. Thor system is completed by cutting edge specific panels. Such panels are made by using an easy to assemble PVC profile that combined with nylon corners and with a gasket system, allows obtaining the T2TB2 classified performance, according to EN 1886 standard.

Cutting conditions of the profiles

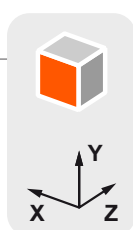
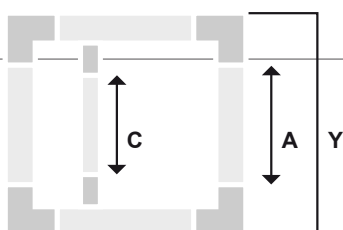

$$A = Y - 100 \text{ mm} / 3.9"$$

$$C = Y - 120 \text{ mm} / 4.68"$$

The formulas are valid for all sides of the module

Y = external dimension

Nylon accessories

THFG503028 Main corner	THFG503128 Joining corner	THFG503228 Omega joint	TECHNICAL DATA
			External dimension 30 mm / 1.18"
Weight: 98 kg/m	Weight: 79 kg/m	Weight: 64 kg/m	Panel thickness 50 mm / 1.97"
			Material PA6 + FV 20%
			Color RAL 7035

THFG503028

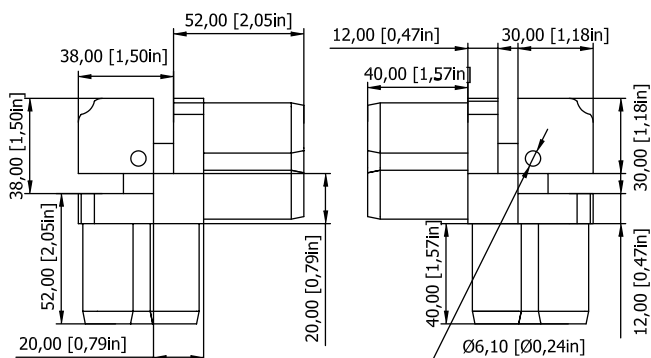

THFG503228

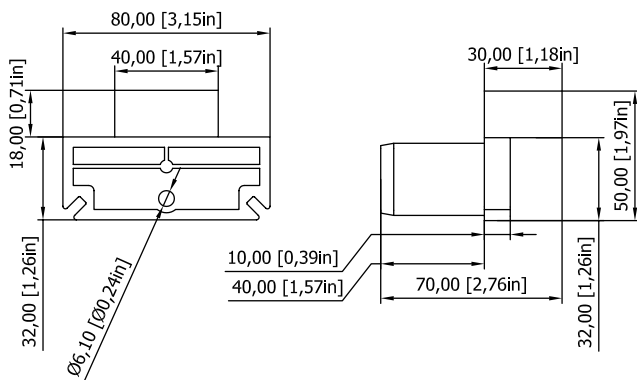

THFG503128

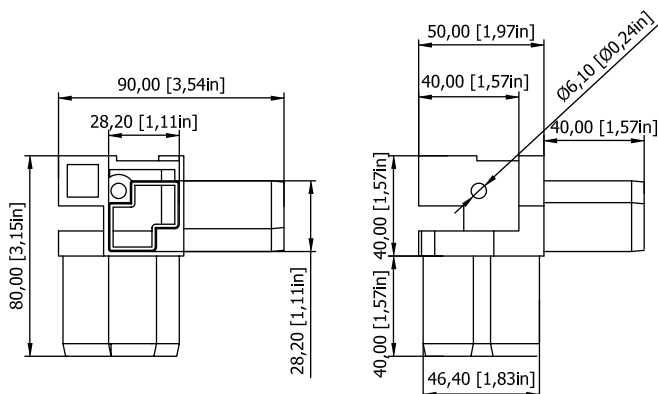

SCREWS DETAILS

THFG503028 main corner	n.1 cylindrical head hexagon screw M6x35 mm (only for cover cup) + n.2 cylindrical head hexagon screw M6x25 mm
THFG503128 joining corner	n.1 cylindrical head hexagon screw M6x35 mm (only for cover cup) + n.2 cylindrical head hexagon screw M6x25 mm
THFG503228 omega joint	n.1 cylindrical head hexagon screw M6x16 mm + n.2 self treading screw, max screw place Ø5,5 mm, max screw head dimension Ø11 mm

Thermal break aluminium profiles

TECHNICAL DATA

Material	EN AW 6060
Treatment	T6
Color	RAL

TH5053-000 Main profile

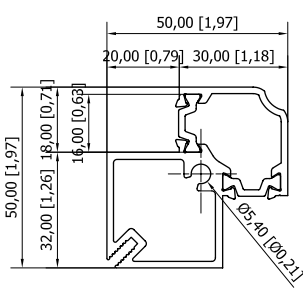
	
External dimension: 30 mm	
Panel thickness: 50 mm	
Weight: 1.370 kg/m	

TH5054-000 Joining profile

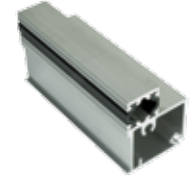
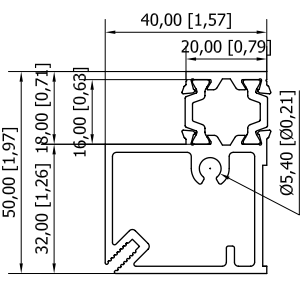

	
External dimension: 30 mm	
Panel thickness: 50 mm	
Weight: 1.350 kg/m	

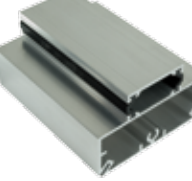
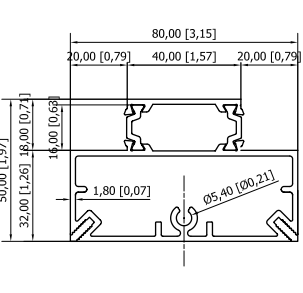
TH5055-000 Omega profile

	
External dimension: 40 mm	
Panel thickness: 50 mm	
Weight: 2.010 kg/m	

Gaskets

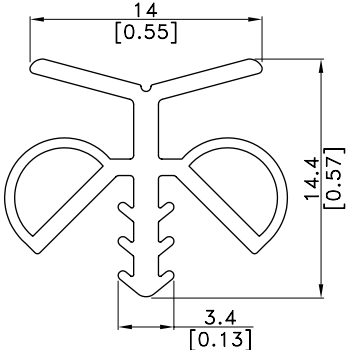
THGUAR-004 Main gasket



Dimension: -

Material: TPE-V

Weight: -

GUAR.020X4 Joining self-sticking gasket





Dimension: 20 x 4 mm

Material: Foamed PVC

Weight: -

Unit connections

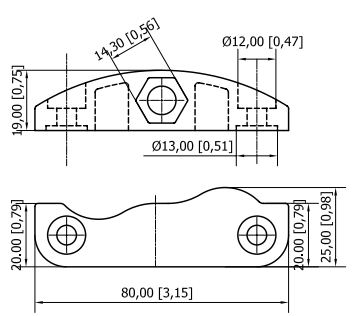
TH5009-000 Unit connection with screws





External dimension: 40 mm

Material: EN AB 46100

Weight: 44 g

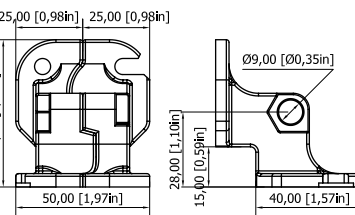
GU-9000000 90° unit connection





External dimension: 40 mm

Material: EN AB 46100

Weight: 116 g

Nylon handles

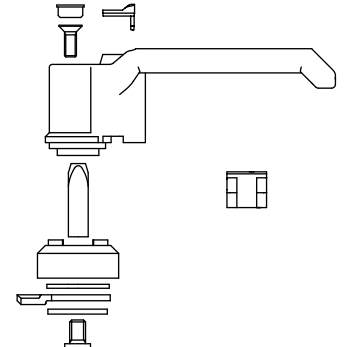
MFG140-044 Nylon handle with external lock





Material: PA6 20% GF

Finish: Natural

Color: RAL

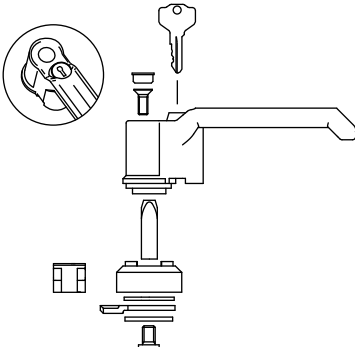
MFG140-045 Nylon handle with external lock with key





Material: PA6 20% GF

Finish: Natural

Color: RAL

Adjustable nylon hinge

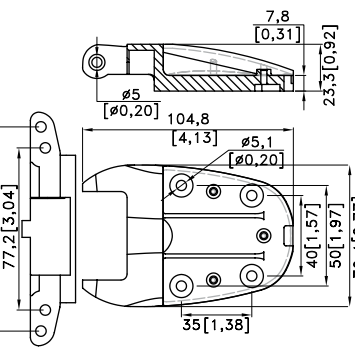
CFG270RTH0 Hinge





Nominal dimension: 105 mm

Material: PA6 20% GF

Weight: 110 g

Aluminium panel block

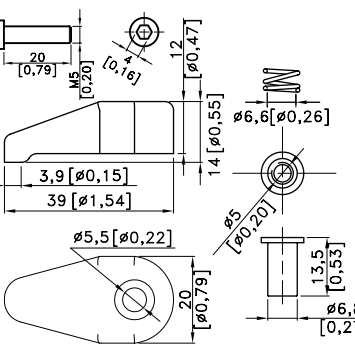
B390000000 Panel block



Nominal dimension: 40 mm

Material: EN AB 46100

Weight: 15 g

Panel

TH5010-000 Nylon corner

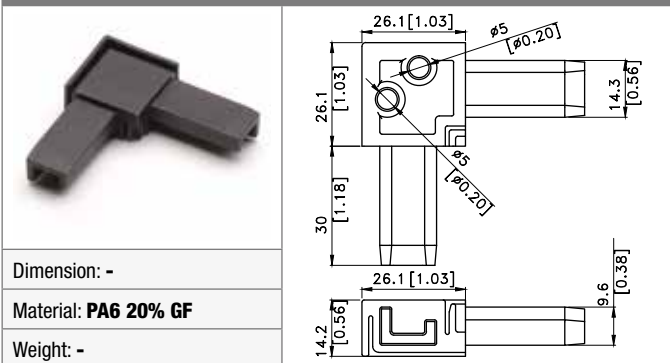

GUAR123600 Gasket corner

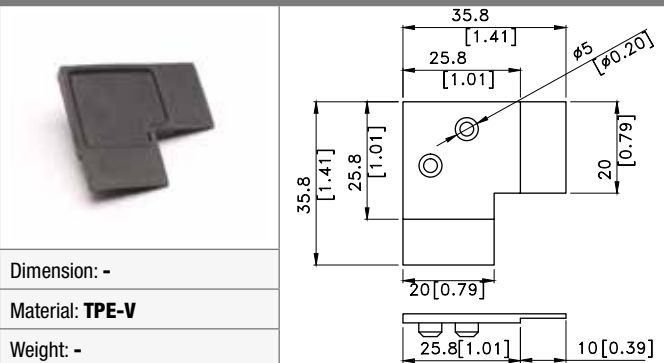

TH5060-000 Profile

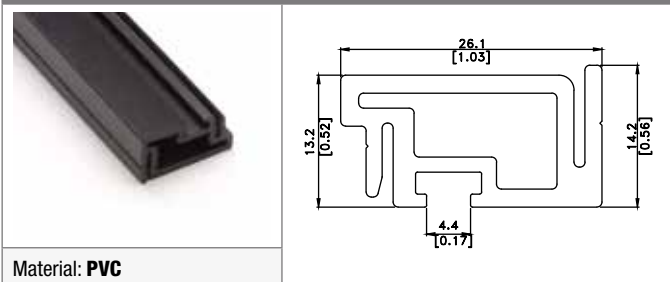

GUAR.00008 Gasket profile

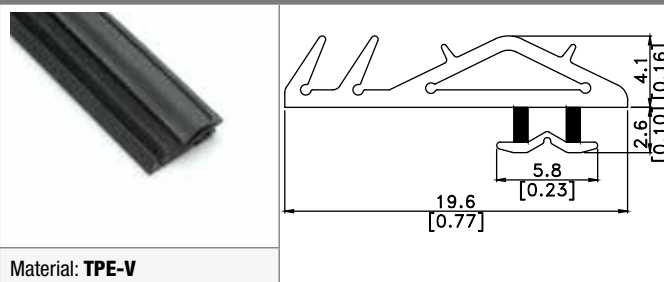

BFG.10THOR Nylon bush

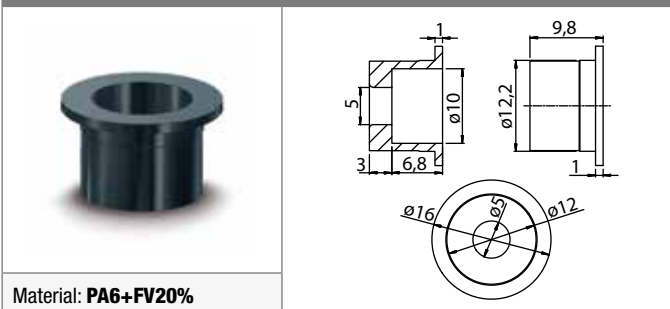

Reference table

	Typology	Cold system
Accessories	Main corner	THFG503028
	Joining corner	THFG503128
	Omega joint	THFG503228
Profiles	Main profile	TH5050-000
	Joining profile	TH5051-000
	Omega profile	TH5052-000
	Main gasket	THGUAR-004
	Joining gasket	GUAR.020X4
	Handles	MFG140/044 - MFG140/045
	Hinge	CFG270RTH0
	Panel block	B390000000
	Unit connections	TH5009-000 - GU-9000000
Panel	Profile	TH5060-000
	Corner	TH5010-000
Panel gasket	Profile	GUAR.00008
	Corner	GUAR123600

