

## Standard system with aluminium corners

Panel thickness 10 mm  
External dimension 20 mm

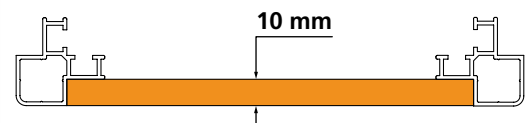

The APS Arosio system is born here.

The standard structure has simple lip profiles available and offers a wide range of combinations. Thanks to its simplicity, it is confirmed among the most used systems by those who deal in AHU. Use practicality and versatility make this system the reference point of all the manufacturers.

### Cutting conditions of the profiles

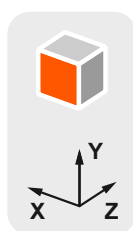
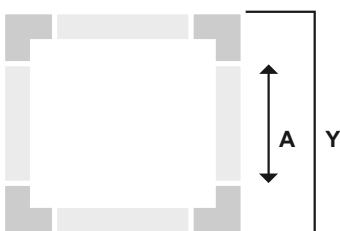

$$A = Y - 70 \text{ mm} / 2.73''$$

The formulas are valid for all sides of the module  
Y = external dimension

# Aluminium accessories

TECHNICAL DATA	
Panel thickness	10 mm / 0.39"
Material	EN AB 46100
Color	RAL

**A230-10000**  
Main corner



Weight: **80 g**

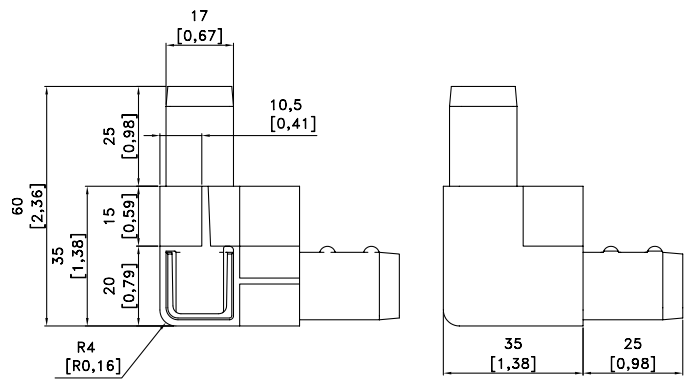

# Aluminium profile

TECHNICAL DATA		Treatment	T6
Material	Extruded aluminium EN AW 6060	Color	RAL

**P120-10000** Main profile



External dimension: <b>20 mm</b>
Panel thickness: <b>10 mm</b>
Weight: <b>0.580 kg/m</b>