

Standard system with aluminium corners

Panel thickness 25 mm
External dimension 30 mm

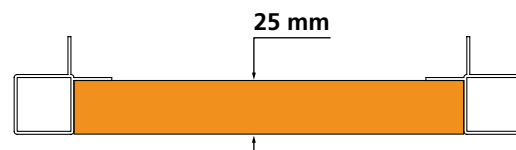

The APS Arosio system is born here.

The standard structure has simple lip profiles available and offers a wide range of combinations. Thanks to its simplicity, it is confirmed among the most used systems by those who deal in AHU. Use practicality and versatility make this system the reference point of all the manufacturers.

Test of air tightness [internal report]

Corner	Profile	sec	Liters	coeff.	area m ²	Transformed f(400)	PR EN 1886:2003 Air leakage
A330-25000	P130-25000	60	28	0,467	4,37	0,2632	L2
		120	54	0,450	4,37	0,2538	L2

Tests carried out with standard assembly product, without using silicone. Dimension of the tested unit: 853x853x730 mm.

Aim of the test was to catalog the actual performance of the APS structures without extra arrangements.

These values have created a starting point to improve our products.

Cutting conditions of the profiles

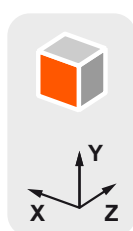
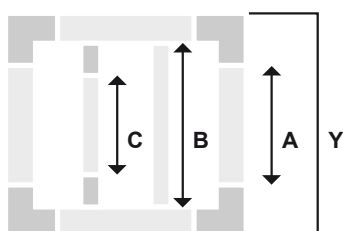

$$A = Y - 100 \text{ mm} / 3.9''$$



$$B = Y - 60 \text{ mm} / 2.34''$$

$$C = Y - 98 \text{ mm} / 3.82''$$

The formulas are valid for all sides of the module

Y = external dimension

Aluminium accessories

A330-25000 Main corner	GOP231-250 Omega joint	TECHNICAL DATA	
		Panel thickness	25 mm / 0.98"
Weight: 135 g	Weight: 48,5 g	Material	EN AB 46100
		Color	RAL

A330-25000

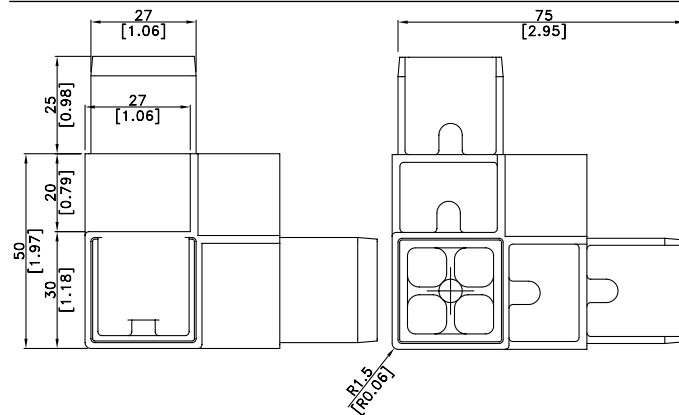

GOP231-250

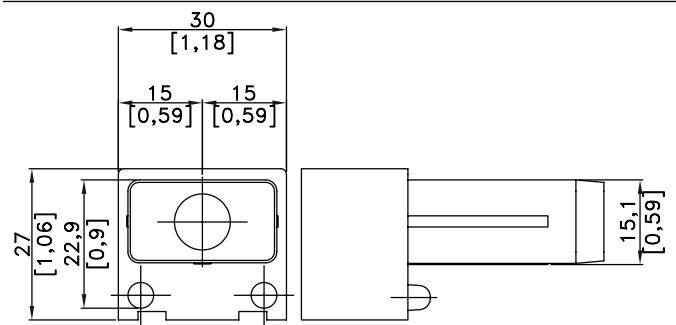

Aluminium profiles

TECHNICAL DATA

Material	Extruded aluminium EN AW 6060
Treatment	T6
Color	RAL

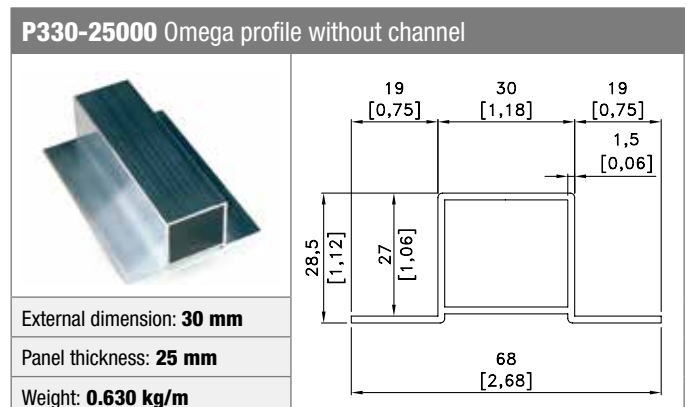
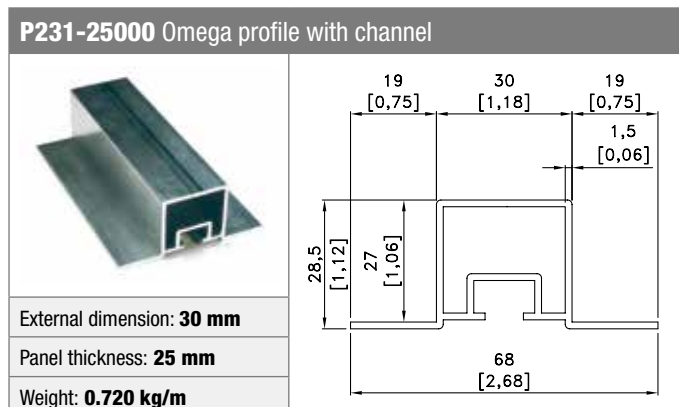
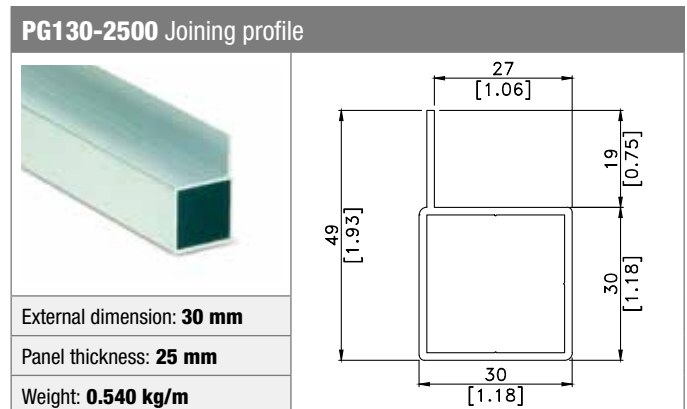
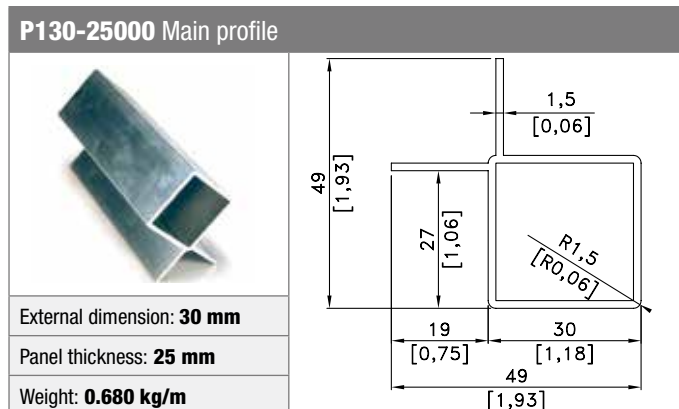

Bases

BAS130-250 Base profile



External dimension: 30 mm
Panel thickness: 25 mm
Weight: 1.930 kg/m

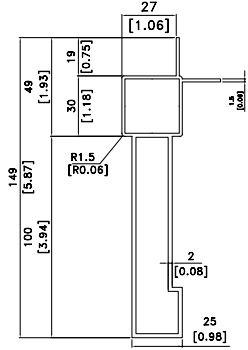

FE-1000000 Corner for base



External dimension: 100 mm
Material: Galvanized steel
Weight: 610 g

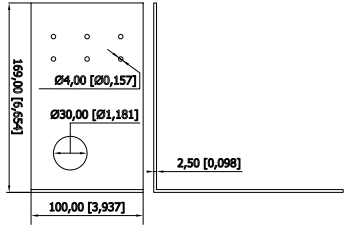

Unit connection

TH5009-000 Unit connection with screws



External dimension: 40 mm
Material: EN AB 46100
Weight: 44 g

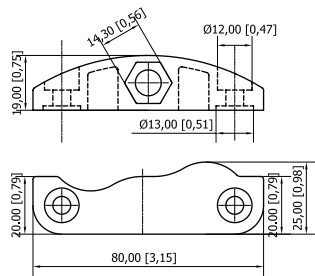

GU-9000000 90° Unit connection



External dimension: 40 mm
Material: EN AB 46100
Weight: 116 g

